

Service description

Product: VM420	Service description No.: 4120-S018	Ver: 1
-------------------	------------------------------------------	-----------

Symptom

The downwards saw movement is too short.

Cause

1. Chips surround the "log stopper" and reduces the movement.
2. Build up of saw chips in the guide groove for "log stopper".
 - Valid for serial no from. 09001 to and including 09085
3. Too much friction between "glide surfaces" that is tube caging the log stopper and the surfaces of the bracket..
4. The hydraulic hose connecting the saw movement cylinder is mounted in incorrect angle
5. Internal leakage in saw cylinder.
6. The saw bar do not move vertically down, but slanted causing the bar to jam.
7. Grooves in the saw bar and blunt saw chain

Solution

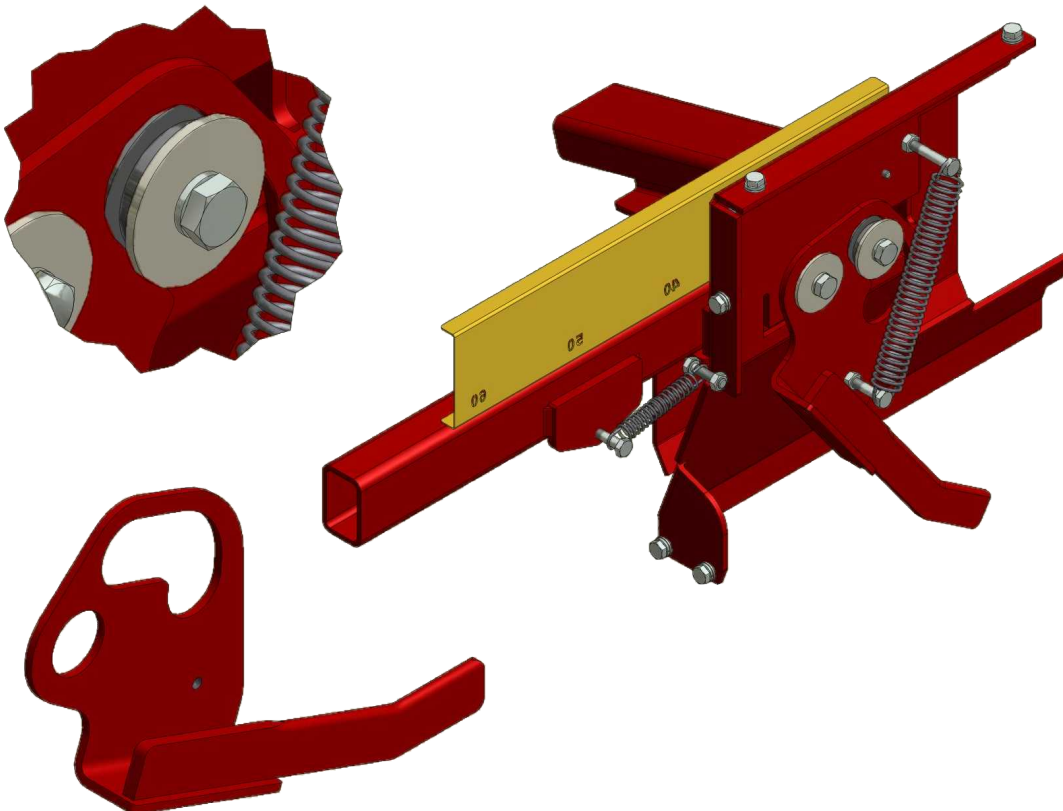

1. Clean the "log stopper" surroundings.
2. Replace bracket 14120070 with new version having a prolonged groove.
3. Lubricate glide surfaces..

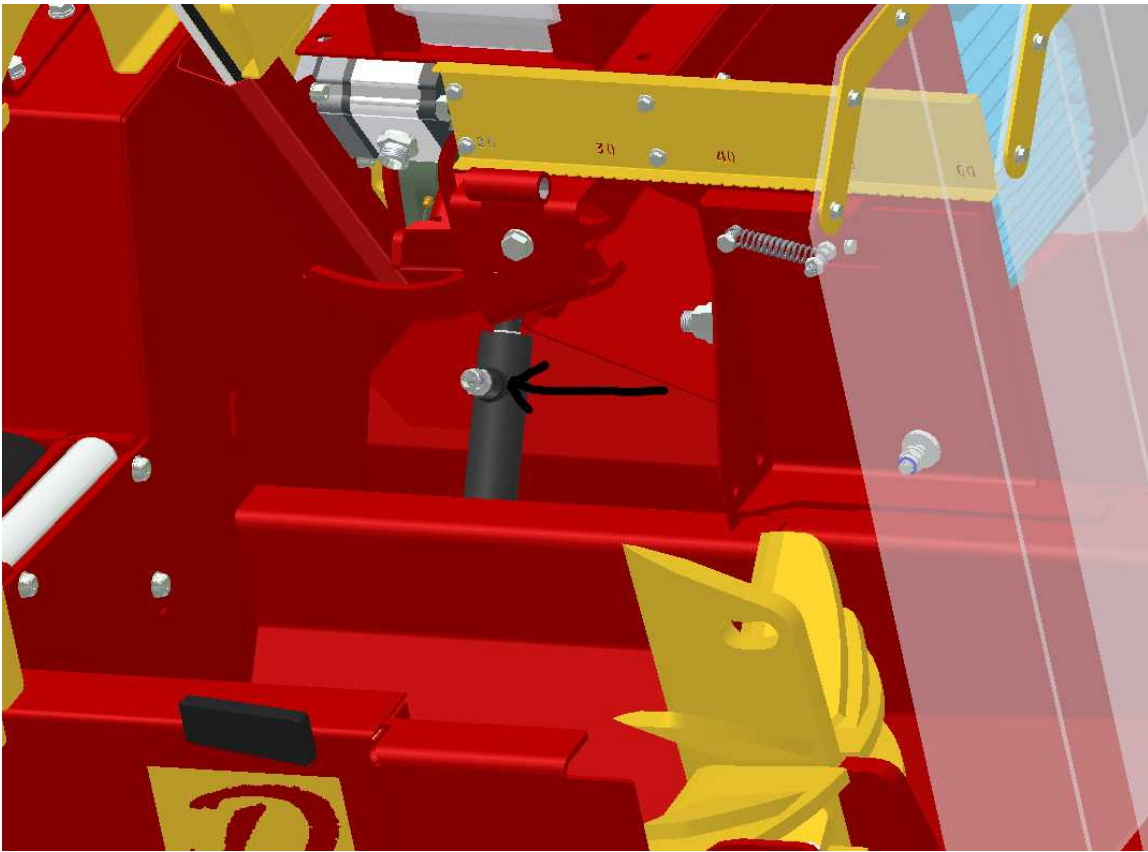

4. The hydraulic hose fastened to the cylinder marked by arrow in the picture shall be 90 degrees on the cylinder. If not correctly mounted it might jam cylinder movement.
5. Replace cylinder
6. See [4120-S005](#).
7. Remove the saw bar and grind eventual grooves in the saw bar. If the groove in the saw bar is too shallow for the saw chain, it must be replaced. It is important to turn the saw bar around regularly to ensure even wear on both sides. Sharpen the saw chain or replace it